



NO.	DATE	BY	REVISION

DRAWN: JFH	APPROVED:	FILENAME: IRR010416	DATE: 1-4-16
------------	-----------	---------------------	--------------

DRAWINGS FOR:
MIDAS & RIVER CITY VET
 HENRICO COUNTY, VIRGINIA
IRRIGATION LAYOUT

SCALE: 1" = 20'
 1 OF 1
 SHEET:
 PROJECT NO.: 1671006

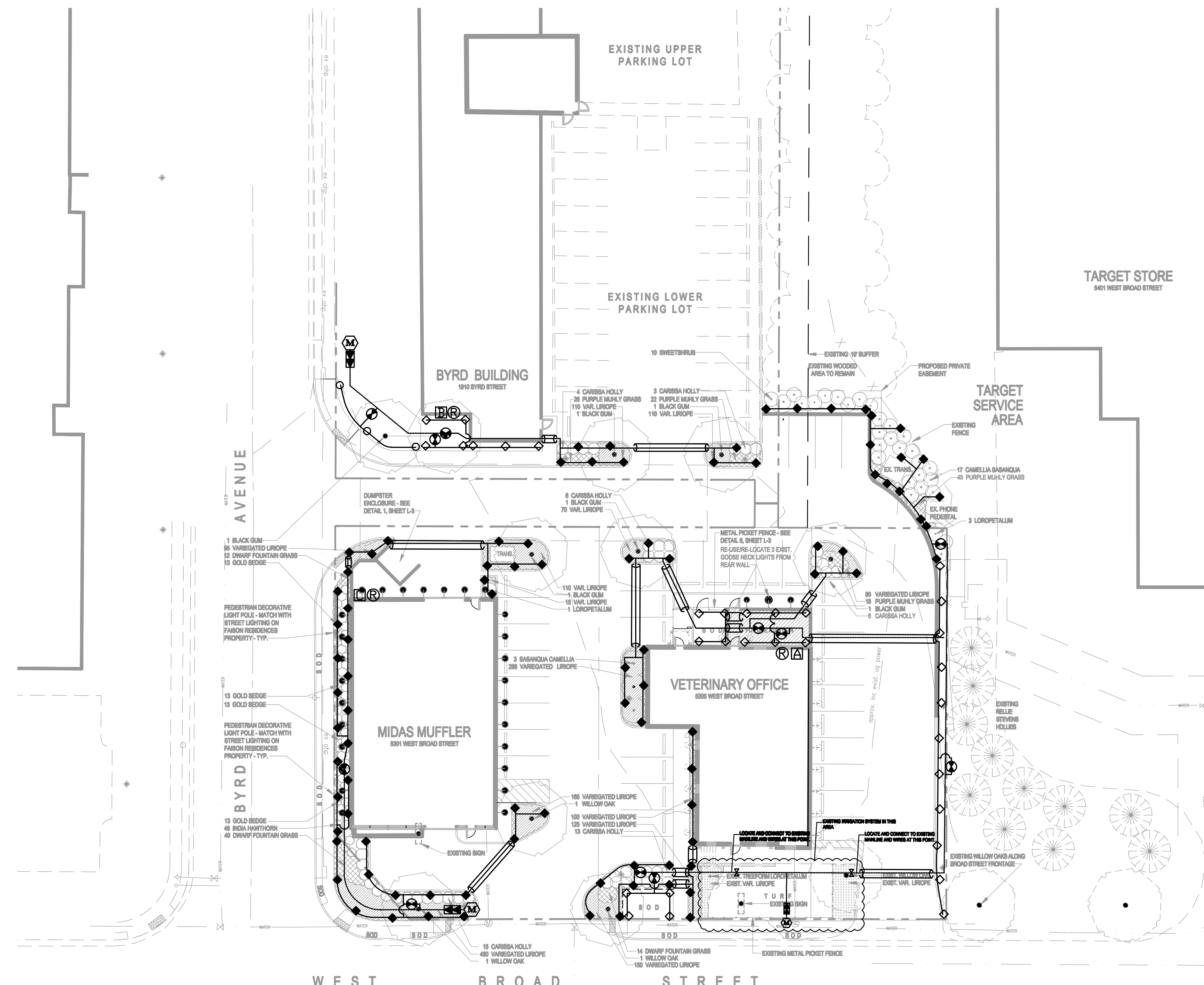

NOTES & LEGENDS

HEADS

- ◆ - TORO 570Z SERIES - 12" HIGH POP SPRINKLER HEAD FITTED WITH PRECISION SERIES SPRAY NOZZLE.
- ◇ - TORO 570Z SERIES - 6" POP UP SPRINKLER HEAD FITTED WITH PRECISION SERIES SPRAY NOZZLE.

PIPE

- DENOTES ROUTE OF 1" PR 200 PVC LATERAL PIPING.
- - - DENOTES ROUTE OF 1" PR 200 MAIN LINE PIPING.

VALVES

- ⊕ - LOCATION OF ELECTRIC 24 V.A.C. REMOTE CONTROL VALVE WITH FLOW CONTROL FEATURE (MODEL # TORO TPVF100).
- ⊗ - LOCATION OF LINE SIZED ISOLATION VALVE.

CONTROLLER

- Ⓐ - LOCATION OF THE EXISTING IRRIGATION CONTROLLER. THE CONTROLLER IS A TORO CUSTOM COMMAND 9-STATION CONTROLLER, MODEL CC-PS.
- Ⓑ Ⓒ - LOCATION OF THE NEW IRRIGATION CONTROLLERS. THE CONTROLLERS SHALL BE TORO TMC SERIES SOLID STATE UNITS WHICH SHALL BE OF THE WALL MOUNT STYLE. THE CONTROLLERS SHALL BE OF THE MODEL NUMBER TMC-424E. THE CONTROLLERS SHALL BE MOUNTED IN THE APPROXIMATE LOCATION SHOWN ON THE PLAN.

- ALL ELECTRICAL CONNECTIONS AND INSTALLATIONS SHALL BE PERFORMED IN ACCORDANCE WITH LOCAL CODE REQUIREMENTS.
- ALL 120 VAC WIRING SHALL BE INSTALLED IN ACCORDANCE WITH ALL APPLICABLE ELECTRICAL CODE REQUIREMENTS.

NOTE: THE OWNER SHALL BE RESPONSIBLE FOR PROVIDING A 120 VAC POWER CIRCUIT AT THE CONTROLLER LOCATION. THE POWER SOURCE SHALL BE CAPABLE OF SUPPORTING A 10 AMPERE LOAD AT 120 VAC.

RAIN SENSOR

- Ⓡ - DENOTES THE LOCATION OF WIRELESS RAIN SENSOR.

BACKFLOW PREVENTION

- Ⓜ - DENOTES THE LOCATION OF REDUCED PRESSURE BACKFLOW PREVENTER ASSEMBLIES WHICH SHALL BE THE RESPONSIBILITY OF THE IRRIGATION CONTRACTOR. THE BACKFLOW SHALL BE 1" IN SIZE.

WATER SUPPLY

- Ⓜ - DENOTES THE LOCATION OF THE PROPOSED IRRIGATION EXCLUSION METERS. THE EXCLUSION METERS SHALL BE THE OWNER'S RESPONSIBILITY. THE EXCLUSION METERS SHALL BE 5/8" IN SIZE.

- THE IRRIGATION SYSTEMS SHALL BE CAPABLE OF DELIVERING 15 GPM AT 70 PSI MAXIMUM WITH ONE STATION OPERATING WITH 40 PSI AT THE BASE OF THE HEAD FOR OPTIMUM PERFORMANCE OF THE IRRIGATION SYSTEM AS DESIGNED AND SPECIFIED.

*** NOTE *** - IF THE WATER SUPPLY IS NOT CAPABLE OF THE DESIGNED CAPACITY (FLOW AND/OR PRESSURE), THE IRRIGATION SYSTEM WILL NEED TO BE REDESIGNED, WHICH MAY ALTER THE IRRIGATION MATERIAL ESTIMATE.

SLEEVING

- Ⓜ - DENOTES LOCATION OF 2" PVC SLEEVES FOR IRRIGATION PIPING.

- WHERE WIRE RUNS OCCUR, A SEPARATE 2" PVC ELECTRICAL CONDUIT SLEEVE SHALL BE USED FOR 24 VAC WIRING PER ELECTRICAL CODE.

- WHERE IRRIGATION PIPING CROSSES SIDEWALKS, THE CONTRACTOR SHALL BE RESPONSIBLE FOR PLACING A SLEEVE 2 SIZES LARGER THAN THE PIPE THAT IS CROSSING THROUGH IT.

NOTE: THE IRRIGATION SYSTEM IS DISPLAYED SCHEMATIC IN NATURE. THE IRRIGATION CONTRACTOR MAY BE REQUIRED TO MAKE MINOR ADJUSTMENTS IN THE FIELD. THESE MINOR ADJUSTMENTS SHALL BE MADE AT NO ADDITIONAL COST TO THE OWNER BUT SHALL BE MADE ONLY AFTER NOTIFICATION IS MADE TO THE OWNER OR HIS REPRESENTATIVE.

- THIS DESIGN IS BASED ON THE SITE INFORMATION AND/OR DRAWINGS SUPPLIED BY THE CLIENT OR RECORD WITH DESIGN CRITERIA BEING SET BY THE CLIENT AND/OR PROJECT OWNER (I.E. AREA TO BE IRRIGATED, MANUFACTURER'S EQUIPMENT TO BE EMPLOYED, WATER SOURCE (LOCATION, FLOW & PRESSURE) CAPACITIES, ELECTRICAL POWER AVAILABILITY FOR IRRIGATION SYSTEM USE, ETC.). SMITH TURF & IRRIGATION BEARS NO RESPONSIBILITY OR LIABILITY FOR ANY ERRORS IN DESIGN OR APPLICATION WHICH MIGHT ARISE DUE TO INACCURACIES IN THE ABOVE REFERENCED INFORMATION SUPPLIED TO SMITH TURF & IRRIGATION IN RELATION TO THIS SPECIFIC PROJECT UNLESS OTHERWISE NOTED.