

SAW CUTTING NOTES

1. CONTRACTOR TO DETERMINE SAWCUT LOCATIONS BASED ON NEW PLUMBING FIXTURES AND EXISTING CONCRETE RAMP LIMITS.
2. SAW CUT CONCRETE SLAB FULL DEPTH PRIOR TO THE REMOVAL OF THE CONCRETE IN DESIGNATED AREAS.
3. DO NOT DISTURB THE EXIST BUILDING FOOTINGS.
4. PROVIDE ADDITIONAL SAW CUT AS REQUIRED BEYOND BUILDING LIMITS FOR NEW SANITARY LINE TIE-IN TO EXISTING SANITARY LINE ALONG FRONT OF BUILDING.

DEMOLITION NOTES

1. DEMOLITION PLANS ARE BASED ON EXIST BUILDING PLANS AND SITE VISITS AND ARE INTENDED AS A REASONABLE REPRESENTATION OF EXIST CONDITIONS.
2. THE DEMOLITION NOTES MAY NOT BE COMPLETE IN IDENTIFYING ALL REMOVALS. VERIFY ACTUAL CONDITIONS AND COORDINATE DEMOLITION WITH NEW WORK SO THAT DEMOLITION IS COMPLETE.
3. THE CONTRACTOR SHALL BE RESPONSIBLE FOR THE THE PROPER DISPOSAL OF ALL MATERIALS REMOVED FROM THE BUILDING.
ALL DIMENSIONS MUST BE VERIFIED IN THE FIELD.
4. SAW CUT CONCRETE SLAB A MINIMUM DEPTH OF 2" PRIOR TO THE REMOVAL OF THE CONCRETE IN DESIGNATED AREAS. THE AREAS OF CONCRETE TO BE REMOVED ARE APPROXIMATE IN SIZE AND LOCATION. THE CONTRACTOR SHALL BE RESPONSIBLE FOR THE REMOVAL OF ALL CONCRETE AS REQUIRED TO COMPLETE THE INTENDED WORK. COORDINATE & VERIFY ALL SAWCUT LOCATIONS WITH PLUMBING CONTRACTOR.

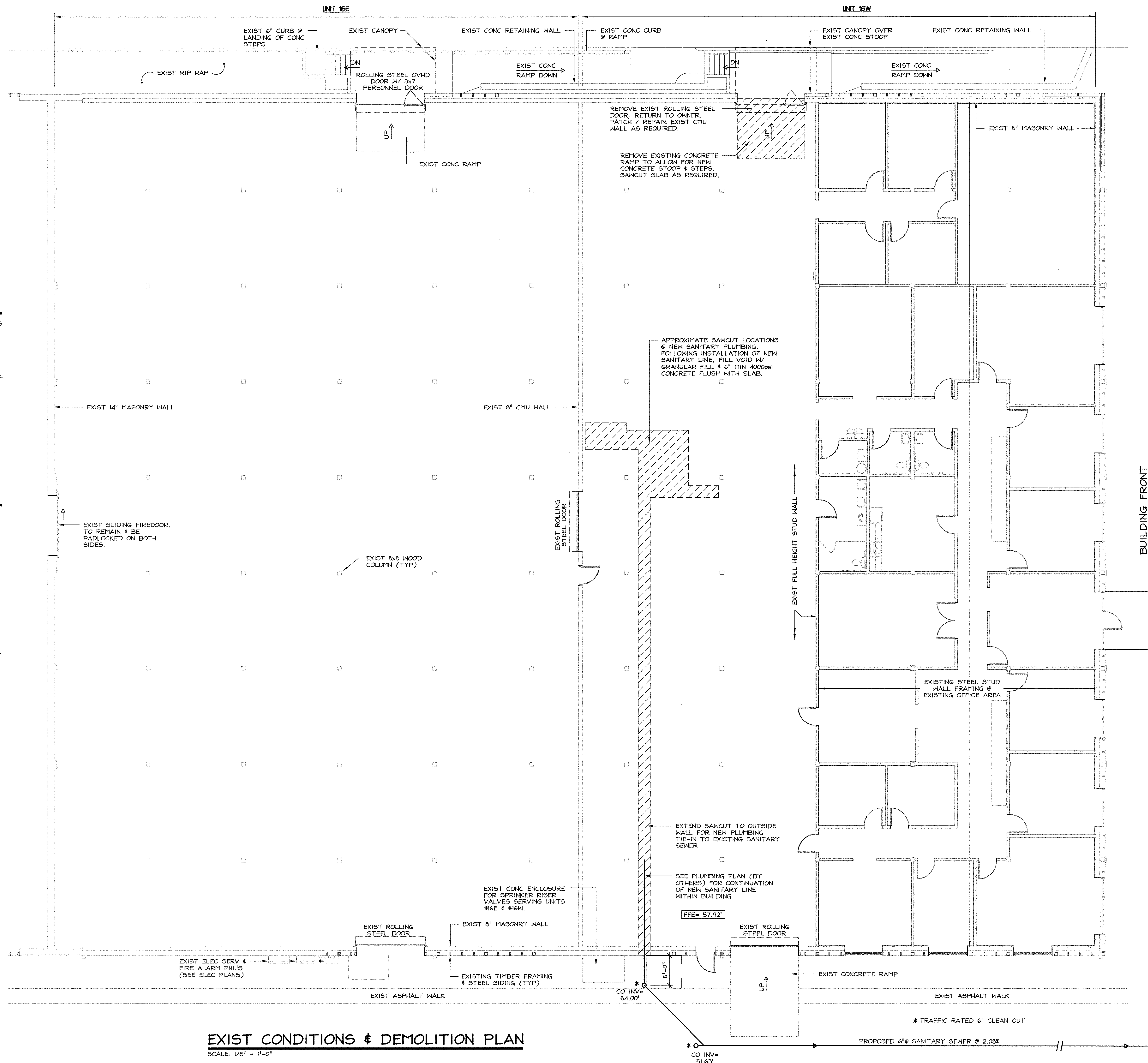

EXIST CONDITIONS & DEMOLITION PLAN

SCALE: 1/8" = 1'-0"

DO NOT SCALE DRAWING FOR DIMENSIONS

EDA
ENGINEERING DESIGN ASSOCIATES

5625 LABURNUM AVENUE
RICHMOND, VIRGINIA 23231
PHONE: 804-236-0190
FAX: 804-236-0194

PO BOX 515
WICOMICO CHURCH 22579
PHONE: 804-580-2227
FAX: 804-580-3334

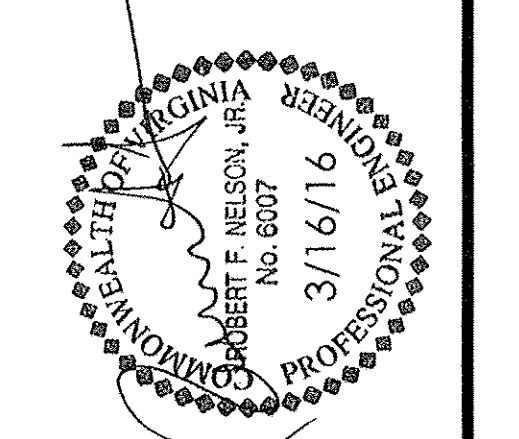

| REVISION NO. | DATE | DESCRIPTION |
|--------------|--------|-------------|
| 1 | 5/2/16 | PERMIT SET |

**UNIT #16 OFFICE EXPANSION
FOR TRAFFORD CORPORATION**
CITY, CENTRAL WAREHOUSE BUILDINGS
COMMERCE ROAD & INGRAM STREET . VIRGINIA
EXISTING CONDITIONS & DEMOLITION PLAN
DRAWN BY: RH / GT
SCALE: 1/8" = 1'-0"
CHECKED BY: RFN
DATE: 5 MARCH 2016
PROJECT NO: 1423